

# STRUCTURE - ARRIERE

## PARE-CHOCS

STYLE (A)

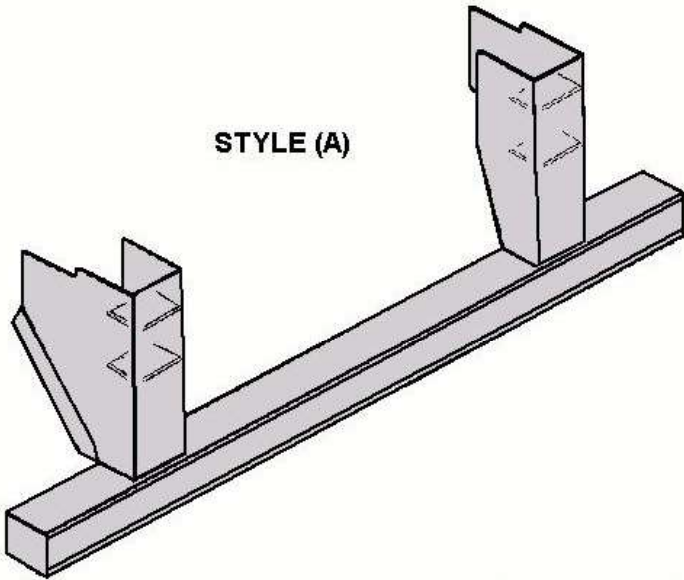

# PIÈCES	MANUFACTURIER	CARACTÉRISTIQUES
4001-1-096	UTILITY	inox / VS 3000R
4001-1-208	VANGUARD	galv. / fourgon réfrigéré
4001-1-210	VANGUARD	inox / fourgon réfrigéré
4001-1-601	GREAT DANE	galv. / boulonné
4001-1-605	GREAT DANE	
4001-1-606	GREAT DANE	
4001-1-650	STRICK	blanc / tube boulonné
4001-1-654	STRICK	gris
4001-1-700	WABASH	
4001-1-701	WABASH	20" avec tube embout ens.
4001-1-702	WABASH	18" avec tube embout ens.
4001-1-703	WABASH	19" avec tube embout ens.
4001-1-704	WABASH	18" avec tube embout ens.
4001-1-900	TRAILMOBILE	
4001-1-936	STOUGHTON	
4001-1-942	STOUGHTON	

STYLE (B)

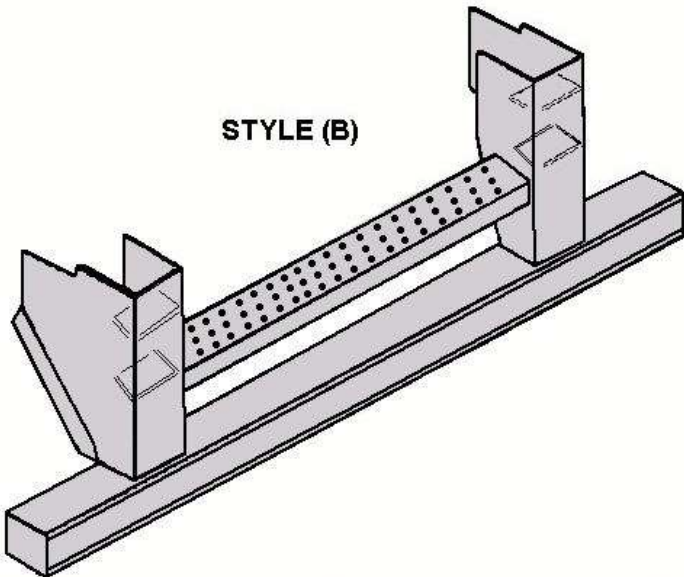

AVEC MARCHEPIED INTERMÉDIAIRE CENTRAL

# PIÈCES	MANUFACTURIER	CARACTÉRISTIQUES
4001-1-209	VANGUARD	galv. / fourgon réfrigéré
4001-1-602	GREAT DANE	
4001-1-932	TRAILMOBILE	

STYLE (C)

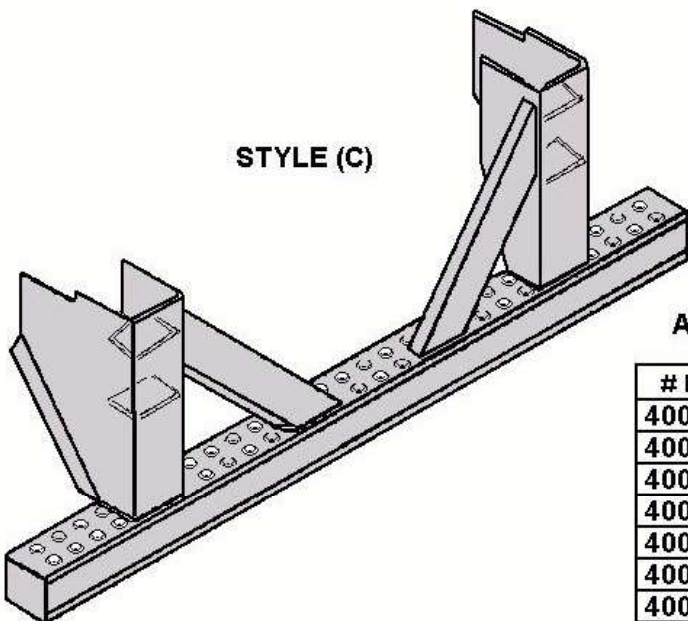

AVEC SUPPORTS TRANSVERSAUX DIAGONAUX

# PIÈCES	MANUFACTURIER	CARACTÉRISTIQUES
4001-1-400	MANAC	
4001-1-603	GREAT DANE	
4001-1-604	GREAT DANE	chassis / boulonné
4001-1-653	STRICK	blanc / tube & supports boulonnés
4001-1-655	STRICK	blanc / supports L boulonnés
4001-1-741	WABASH	inox / fourgon réfrigéré
4001-1-910	TRAILMOBILE	galv. / boulonné

# STRUCTURE - ARRIERE

## PARE-CHOCS

**A**

### ENTRETOISE VERTICALE

4001-1-707 L/R	4001-1-728 L/R
4001-1-710	4001-1-939 L/R
4001-1-716	4001-1-940 L/R
4001-1-726	4001-1-945

**B**

### MONTANT VERTICAL

4001-1-937	4001-1-706
4001-1-938	4001-1-709
4001-1-944	4001-1-715
4001-1-651 L/R	4001-1-725
4001-1-652 L/R	4001-1-609
4001-1-656 L/R	4001-1-609 SS
4001-1-201 L/R	4001-1-610
4001-1-204 L/R	4001-1-610 SS
4001-1-218 L/R	4001-1-612
4001-1-275 L/R	4001-1-612 HD
4001-1-283 L/R	

**C**

### BUTÉE & RENFORT

4001-1-213 L/R	4001-1-718
4001-1-216 L/R	4001-1-611 L/R
4001-1-708	4001-1-946
4001-1-711	4001-1-657 L/R

**D**

### EMBOUT EN "S" WABASH

4001-1-705	4001-1-717
4001-1-712	4001-1-727

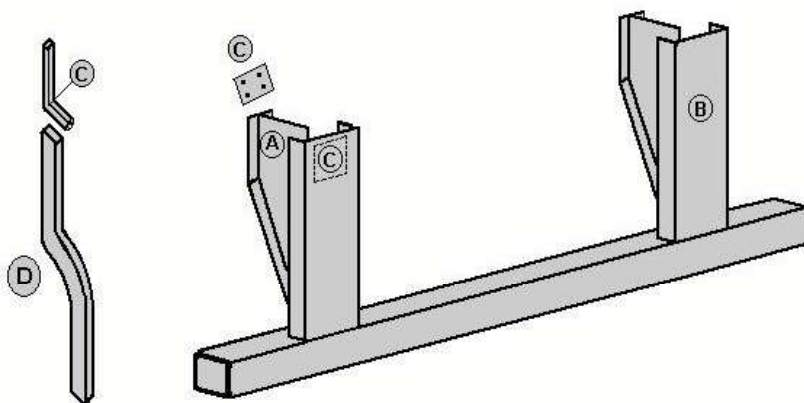

### MARCHEPIED

4001-1-206
4001-1-207
4001-1-211SS
4001-1-212
4001-1-215 L/R

### MONTANT DIAGONAL

4001-1-205 L/R
4001-1-214

# STRUCTURE - ARRIERE

## PARE-CHOC - TUBE TRANSVERSAL

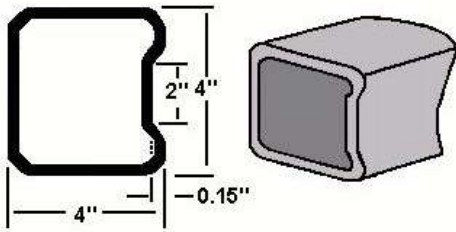

<b>4001-1-401</b>	MANAC	naturel
<b>4001-1-401G</b>	MANAC	galvanisé
<b>4001-1-720G</b>	HYUNDAI	naturel

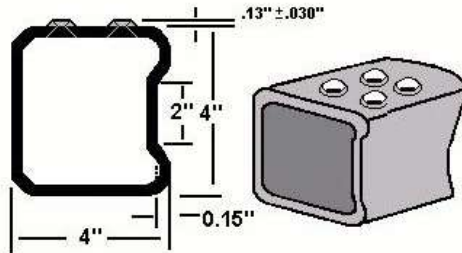

<b>4001-1-902</b>	TRAILMOBILE	
<b>4001-1-983</b>	STOUGHTON	4" x 4" x 94"

VANGUARD

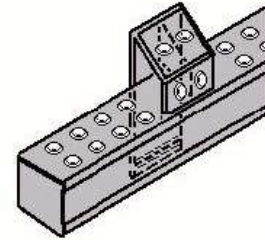

VANGUARD

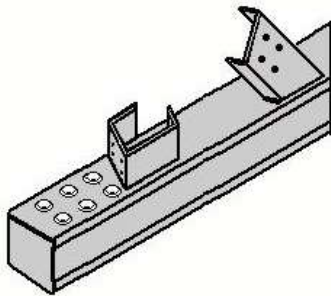

VANGUARD

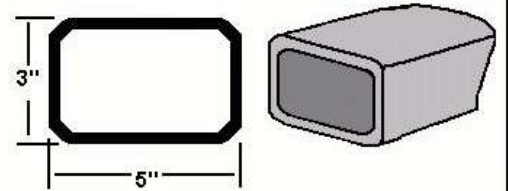
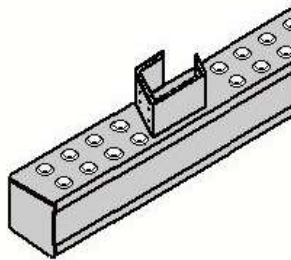

<b>4001-1-200</b>	non-isolé	galv.	à boulonner
-------------------	-----------	-------	-------------

<b>4001-1-203</b>	non-isolé	galv.	à boulonner
-------------------	-----------	-------	-------------

<b>4001-1-620</b>	GREAT DANE	3" x 5" x 94-3/8"
<b>4001-1-742</b>	WABASH	2" x 4" x 66"

GREAT DANE

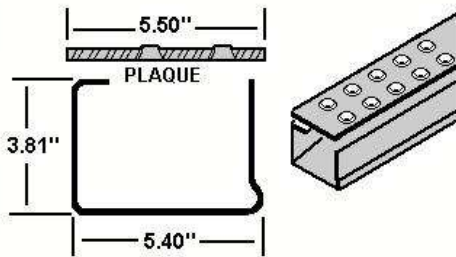

STOUGHTON

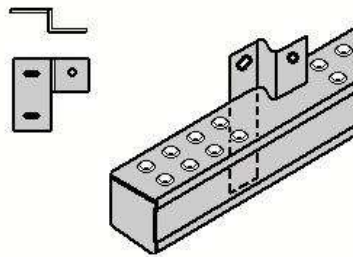

WABASH

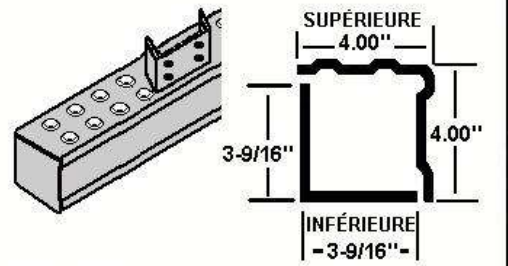

<b>4001-1-600 A</b>		INOX	
<b>4001-1-600 B</b>		INOX	PLAQUE

<b>4001-1-943</b>		acier naturel	
-------------------	--	---------------	--

<b>4001-1-729</b>	réfrigéré	supérieure	95" long
<b>4001-1-730</b>	réfrigéré	inférieure	95" long

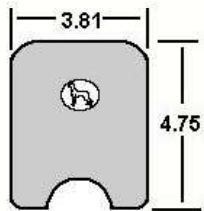

### PLAQUE - EMBOUT POUR TUBE

<b>4001-1-607</b>	GREAT DANE	acier	4-13/16" X 3-1/2" X 1/8"
<b>4001-1-607SS</b>	GREAT DANE	INOX	4-13/16" X 3-1/2" X 1/8"
<b>4001-1-608</b>	GREAT DANE	acier	4-13/16" X 4-3/4" X 1/8"
<b>4001-1-941</b>	STOUGHTON	INOX	